

ø60.5开孔详图  
DRILLING DETAIL

1:2

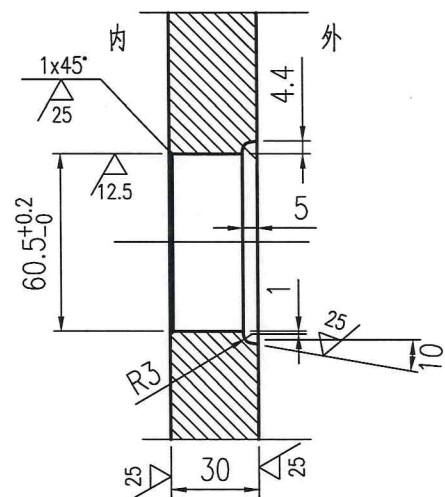

管孔排列详图  
ARRANGE DETAIL

1:4

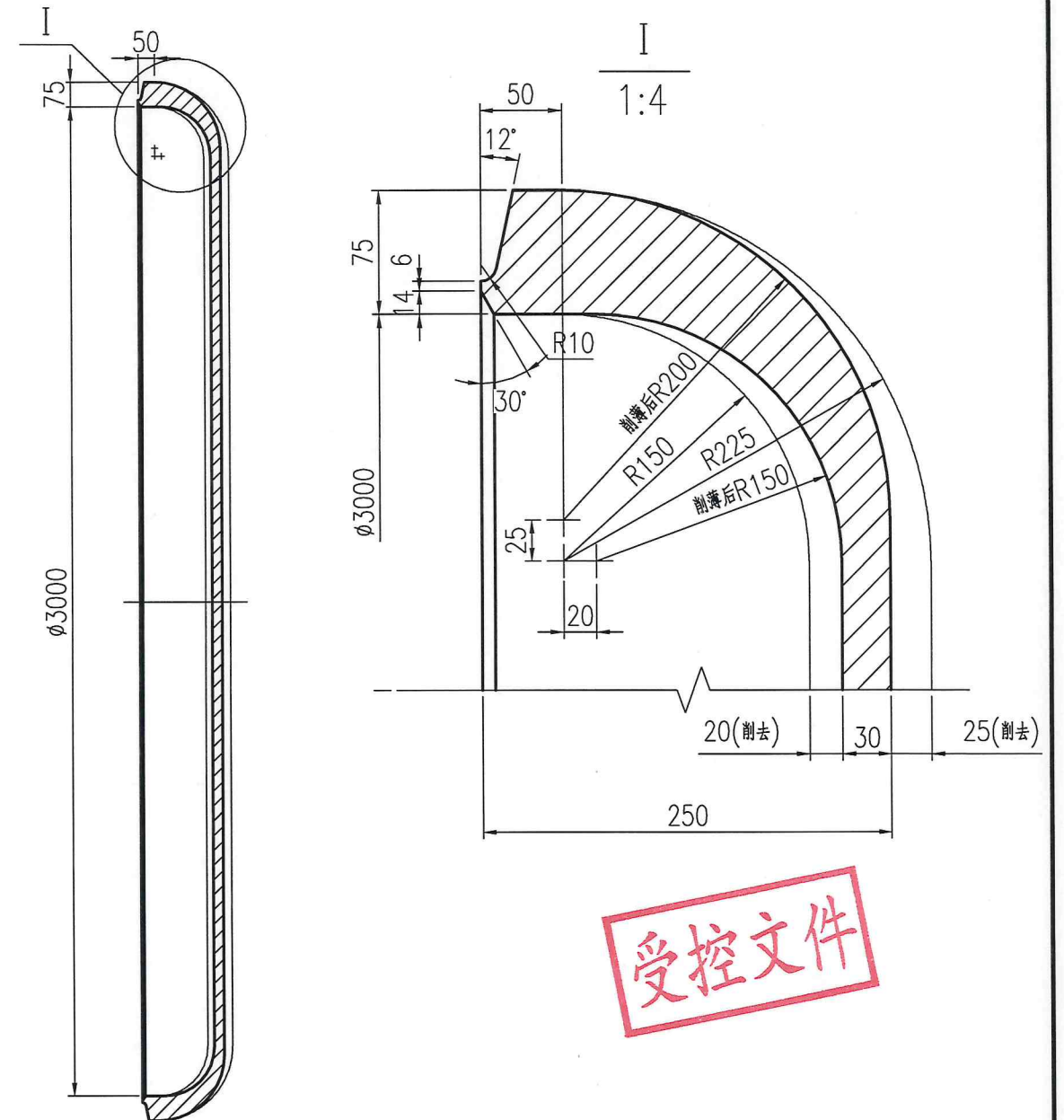
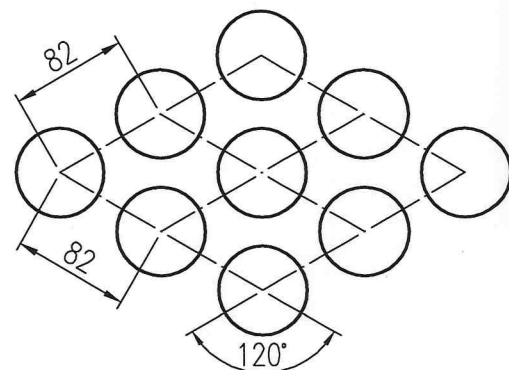

技术要求:

- 1.本封头采用整板热压成型,不允许拼接。
- 2.封头同一断面直径差值不大于1.5mm,内径偏差为±5mm,削薄前管板平面度不大于10mm。
- 3.管孔划线偏差不得大于1.50mm,钻孔之前应经过签名验收手续。

Technical Notes:

- 1.This header shall be formed by hotcompacting. It's fobbiden to made of parts.
- 2.Differential length of radius at same cross-section shall be less than 1.5mm. The allowable tolerance of inside diameter shall be controlled in ±5mm. The plane measure of header shall be less than 10 mm.
- 3.The allowable toerance of all the lines that connect collinear central points from head to end will be less than 1.50mm.

					江苏索普赛瑞装备制造有限公司 Jiangsu SOPO-CERE Equipment Manufacturing CO. Ltd.		
					SA-516 Gr.70		前平管板 ID3000 t=75
					FRONT TUBESHEET		
MARK 标记	TOTAL NO. 处数	FILE NO. 更改文件号	SIGN 签名	DATE 日期	WEIGHT(kg) 重量	SCALE 比例	REV. 版次
DESIGN 设计	许大宇 2024.2.19		SERIAL# 产品编号		3053	1:20	0
APPROVE 批准	赵晓梅 2024.2.19		24-1004GQI/24-1005GQI 24-1006GQI/24-1007GQI		TOTAL-PAGES 共 张	No.-PAGE 第 张	
					11SCG2402-2-2		

本图纸及相关文件版权属于江苏索普赛瑞装备制造有限公司所有,任何单位和个人未经江苏索普赛瑞装备制造有限公司书面许可,不得以任何方式复制或扩散至第三方,违者应负相应法律责任。  
THIS DRAWING AND RELEVANT DOCUMENT'S COPYRIGHT BELONGS TO SOPO-CERE EQUIPMENT MANUFACTURING CO., LTD. THEY MAY NOT BE REPRODUCED OR DISCLOSED TO ANY THIRD PARTY IN ANY FORM WITHOUT THE PRIOR WRITTEN PERMISSION OF Jiangsu SOPO-CERE EQUIPMENT MANUFACTURING CO., LTD. THE OFFENDERS SHALL BEAR THE CORRESPONDING LEGAL RESPONSIBILITY.



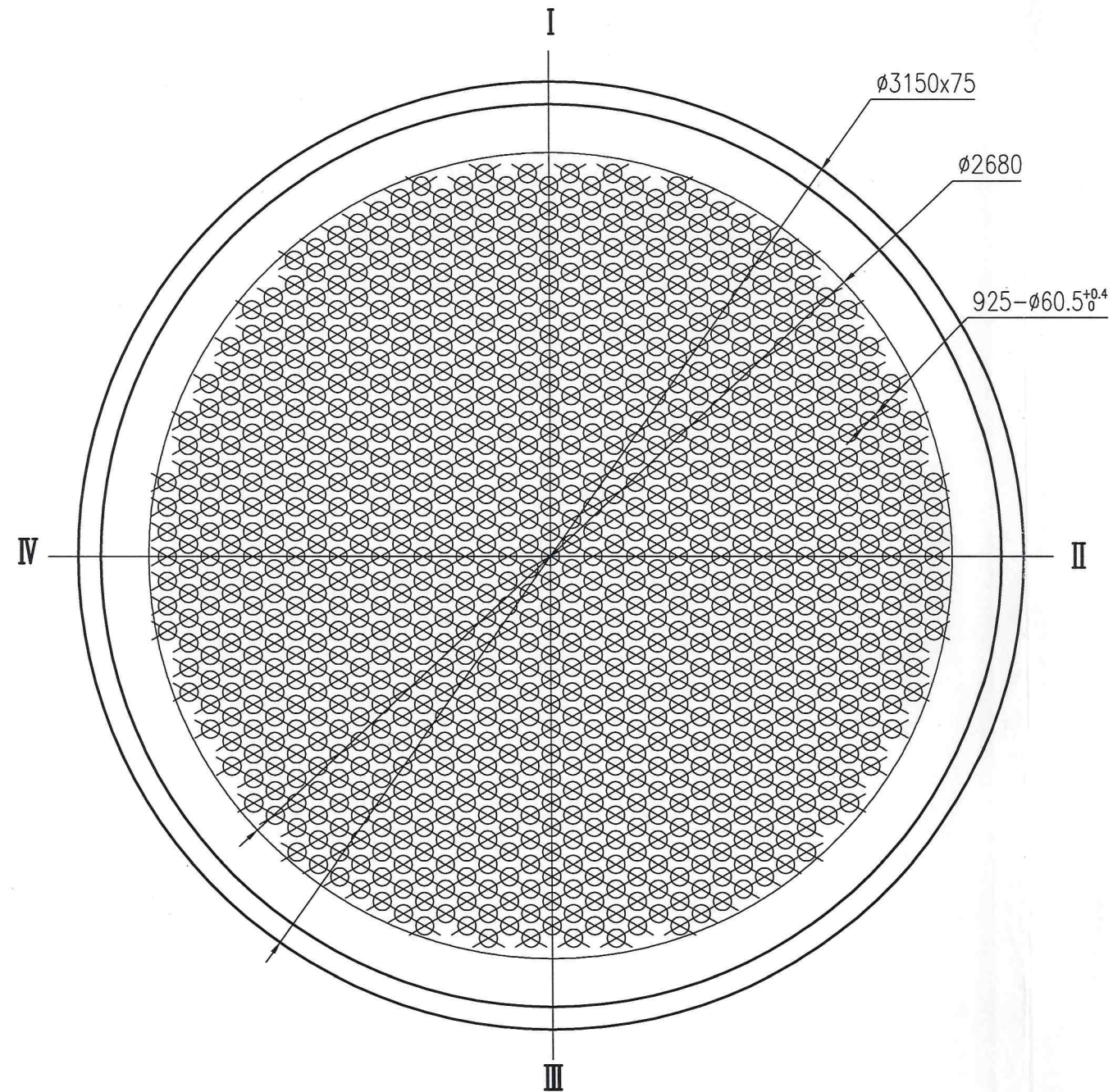

ø60.5开孔详图  
DRILLING DETAIL

1:2

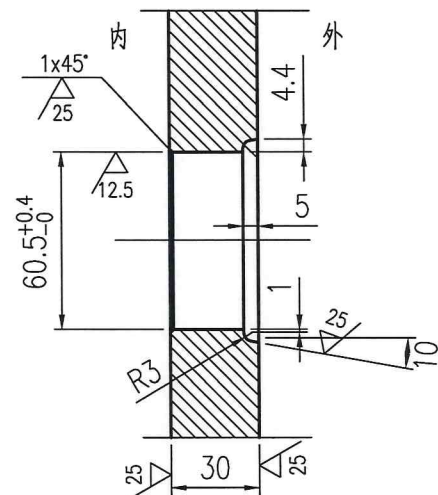

管孔排列详图  
ARRANGE DETAIL

1:4

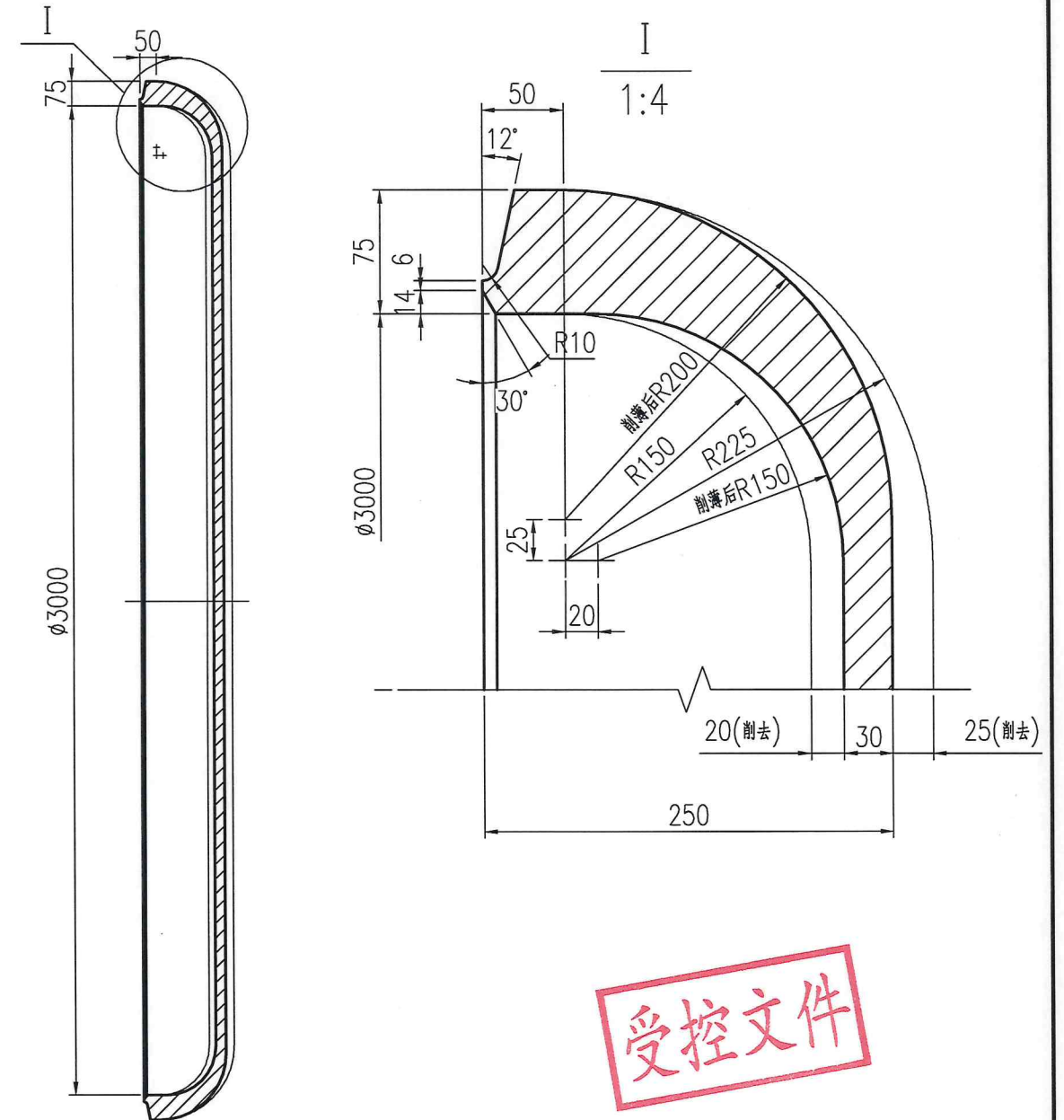
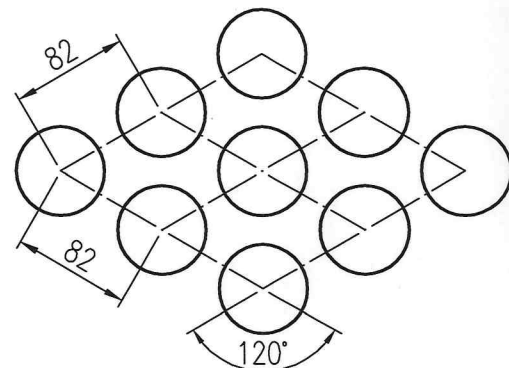

受控文件

技术要求:

- 1.本封头采用整板热压成型,不允许拼接。
- 2.封头同一断面直径差值不大于1.5mm,内径偏差为±5mm,削薄前管板平面度不大于10mm。
- 3.管孔划线偏差不得大于1.50mm,钻孔之前应经过签名验收手续。

Technical Notes:

- 1.This header shall be formed by hotcompacting. It's fobbiden to made of parts.
- 2.Differential length of radius at same cross-section shall be less than 1.5mm. The allowable tolerance of inside diameter shall be controlled in ±5mm. The plane measure of header shall be less than 10 mm.
- 3.The allowable toerance of all the lines that connect collinear central points from head to end will be less than 1.50mm.

					江苏索普赛瑞装备制造有限公司 Jiangsu SOPO-CERE Equipment Manufacturing CO. Ltd.		
					SA-516 Gr.70		后平管板 ID3000 t=75
					TAIL TUBESHEET		
MARK 标记	TOTAL NO. 处数	FILE NO. 更改文件号	SIGN 签名	DATE 日期	WEIGHT(kg) 重量	SCALE 比例	REV. 版次
DESIGN 设计	许大宇 2024.2.19		SERIAL# 产品编号		3053	1:20	0
APPROVE 批准	赵晓梅 2024.2.19		24-1004GQ1/24-1005GQ1 24-1006GQ1/24-1007GQ1		TOTAL-PAGES 共 张	No.-PAGE 第 张	
					11SCG2402-2-3		

本图纸及相关文件版权属于江苏索普赛瑞装备制造有限公司所有,任何单位和个人未经江苏索普赛瑞装备制造有限公司书面许可,不得以任何方式复制或扩散至第三方,违者应负相应法律责任。  
THIS DRAWING AND RELEVANT DOCUMENT'S COPYRIGHT BELONGS TO SOPO-CERE EQUIPMENT MANUFACTURING CO. LTD. THEY MAY NOT BE REPRODUCED OR DISCLOSED TO ANY THIRD PARTY IN ANY FORM WITHOUT THE PRIOR WRITTEN PERMISSION OF Jiangsu SOPO-CERE EQUIPMENT MANUFACTURING CO. LTD. THE OFFENDERS SHALL BEAR THE CORRESPONDING LEGAL RESPONSIBILITY.



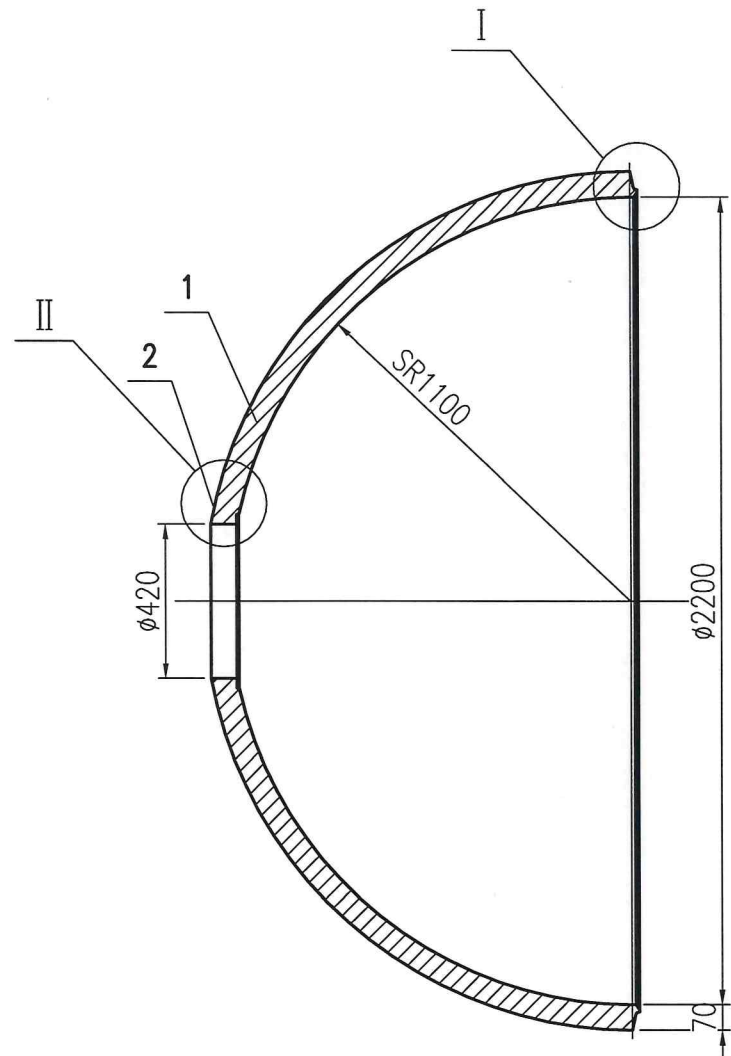

I  
1:4

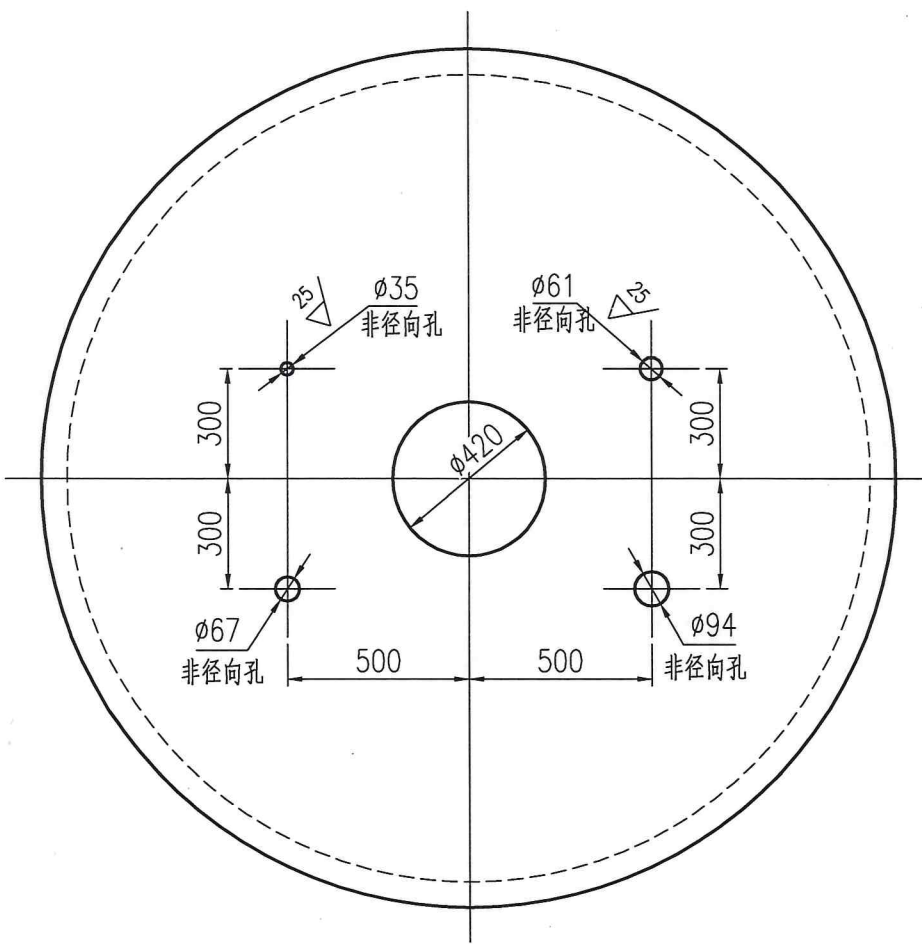

II  
1:4

注.成型后厚度不得低于64.4mm.  
Note: The thickness shall not be less than 64.4mm.

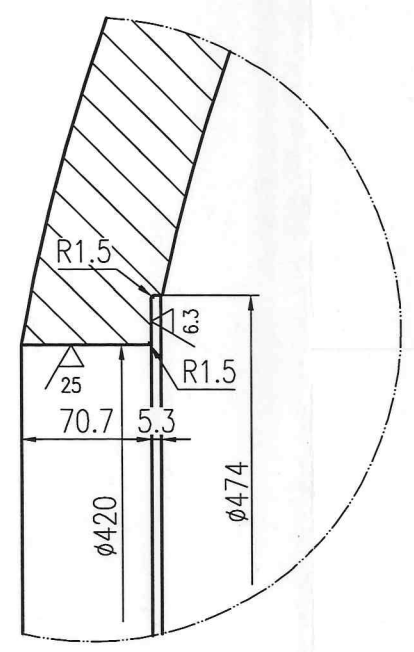
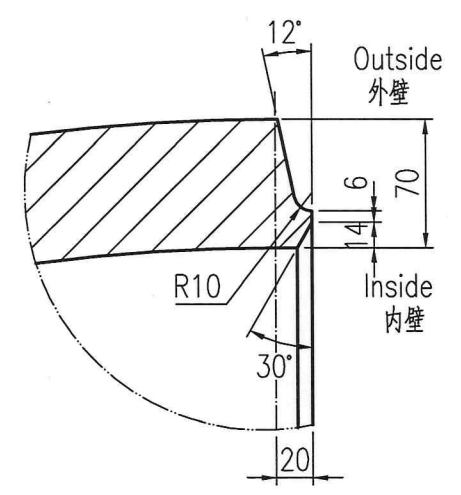

受控文件

					江苏索普赛瑞装备制造有限公司 Jiangsu SOPO-CERE Equipment Manufacturing CO. Ltd.			SA-516 Gr.70 球形封头 ID2200 t=70 HEAD
MARK 标记	TOTAL NO. 处数	FILE NO. 更改文件号	SIGN 签名	DATE 日期	WEIGHT(kg) 重量	SCALE 比例	REV. 版次	
DESIGN 设计	许大宇 2024.2.19		SERIAL# 产品编号		4660	1:20	0	
APPROVE 批准	赵晓梅 2024.2.19		24-1004QB/24-1005QB 24-1006QB/24-1007QB		TOTAL-PAGES 共 张	No.-PAGE 第 张		
					11SCG2402-1-2			

本图纸及相关文件版权属于江苏索普赛瑞装备制造有限公司所有,任何单位和个人未经江苏索普赛瑞装备制造有限公司书面许可,不得以任何方式复制或扩散至第三方,违者应负相应法律责任。  
THIS DRAWING AND RELEVANT DOCUMENT'S COPYRIGHT BELONGS TO SOPO-CERE EQUIPMENT MANUFACTURING CO., LTD. THEY MAY NOT BE REPRODUCED OR DISCLOSED TO ANY THIRD PARTY IN ANY FORM WITHOUT THE PRIOR WRITTEN PERMISSION OF Jiangsu SOPO-CERE EQUIPMENT MANUFACTURING CO., LTD. THE OFFENDERS SHALL BEAR THE CORRESPONDING LEGAL RESPONSIBILITY.